

## Installation Instructions

Smartbears Wireless series of products must be used with ePatron, you can add more than one of Smartbears products to a single ePatron



— 1 —

2019-07-24

Read the manual before you construction.

Notice:

1. We prefer the installation personnel have the license, and follow the manual processes.
2. Use the proper wire and do not overload. The maximum overload is 250V AC, 2A(500W).
3. Use the appropriate wires to connect the plug.
4. The product is indoor use, and do not put the product in wet, high temp or outdoor use.
5. For the safety, do not unplug the plug when you hands are wet.

— 2 —

## 1 Smart Plug set installation instructions

Take off the cover

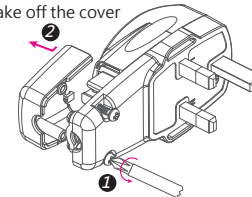

Use the Phillip screwdriver to release screws.

**!** Please be sure to switch on the power.



Strip the wire  
Cable: 0.75~1.5MM<sup>2</sup>\*3C

— 3 —

See the Picture, put the wires to the position and lock the wires with screws.

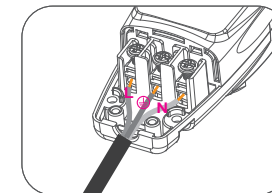

"⊕" Screw: Ground Line

After you screw the wires, make sure the wires are sitting properly and close the cover.

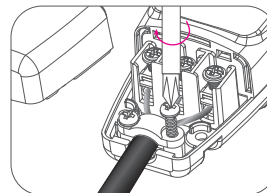

"L" Screw: Live Line

"N" Screw: Neutral Line

— 4 —

After you finish installation, you can plug into the socket and start to use. Enjoy the Smarthome system.

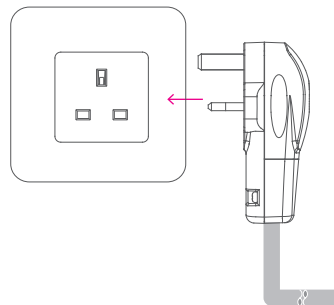

— 5 —

## 2 Add Device

Open "Smartbears" app. at your mobile as below:

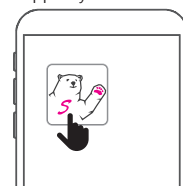

Please make sure the power is on, or it won't work if not.

Notes: Smartbears series products should be attached with Smartbears hub, you can control different devices in one ePatron. Please refer to the user manual for the hub and App.

— 6 —

Enter the Smartbears App and the Hub list

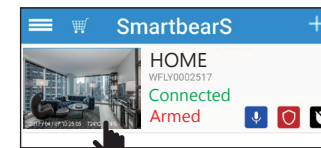

After the hub connected successfully, choose the hub you want to add the device

— 7 —

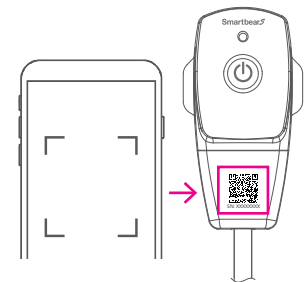
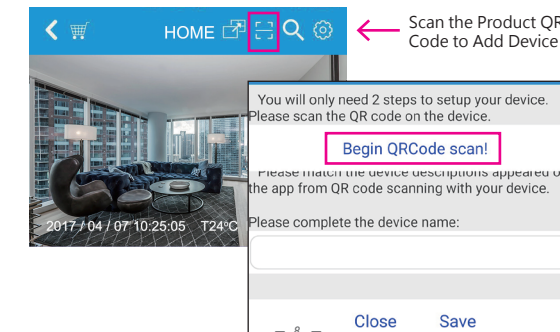

Select the QR code in the SmartBears App, and scan the QR code which is in the smart plug. The App will jump out all the information, and choose "save" the device will in you list.

Note: You can change the name of the device in App that make you easier to control.

— 9 —

## 3 Switch control

After the setting there are two ways to control the device A or B.

- A You can use the mobile phone to control. (Page11, 12)
- B You can control the device by touch the device. (Page13)



Make sure the device is on power, or otherwise you cannot operation these processes.

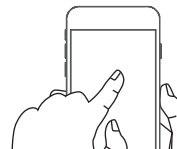

— 10 —

**A** Use the mobile phone to control.

After added device, return the main window

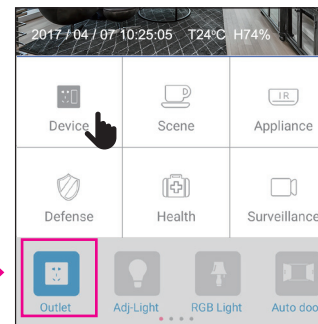

Choose the Outlet →

— 11 —

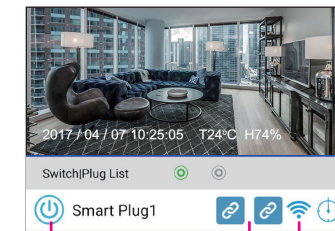

Turn on/off the power

Scene mold setting  
Blue button will change with different scene

In the interface of "SwitchPlug List", click the added device-Smart Plug, then you can remote control switch and different home appliances, including manual operation switch, auto control, timing control, Scene combination.

Smart Plug name, area, timing setting, deleting etc.

Wifi status

— 12 —

**B** Touch the panel to control the circuits.

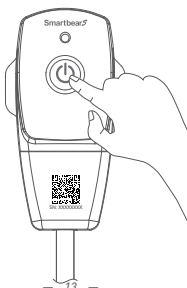

— 13 —



Please scan the following QR code to download detailed Smartbears APP user manual



— 14 —

FCC statement

This device complies with Part 15 of the FCC Rules. Operation is subject to the following two conditions: (1) This device may not cause harmful interference, and (2) this device must accept any interference received, including interference that may cause undesired operation. Caution: Changes or modifications not expressly approved by the party responsible for compliance could void the user's authority to operate the equipment. NOTE: This equipment has been tested and found to comply with the limits for a Class B digital device, pursuant to part 15 of the FCC Rules. These limits are designed to provide reasonable protection against harmful interference in a residential installation. This equipment generates, uses and can radiate radio frequency energy and, if not installed and used in accordance with the instructions, may cause harmful interference to radio communications. However, there is no guarantee that interference will not occur in a particular installation. If this equipment does cause harmful interference to radio or television reception, which can be determined by turning the equipment off and on, the user is encouraged to try to correct the interference by one or more of the following measures:

- Reorient or relocate the receiving antenna.
- Increase the separation between the equipment and receiver.
- Connect the equipment into an outlet on a circuit different from that to which the receiver is connected.
- Consult the dealer or an experienced radio / TV technician for help.

— 15 —



Taiwan



China

— 16 —